

DO NOT SCALE DRAWING WORK TO FIGURE

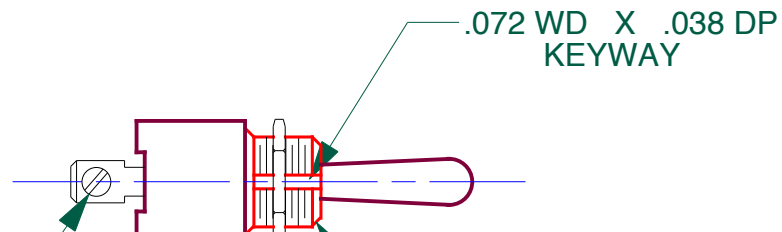

SCREW TERM'S

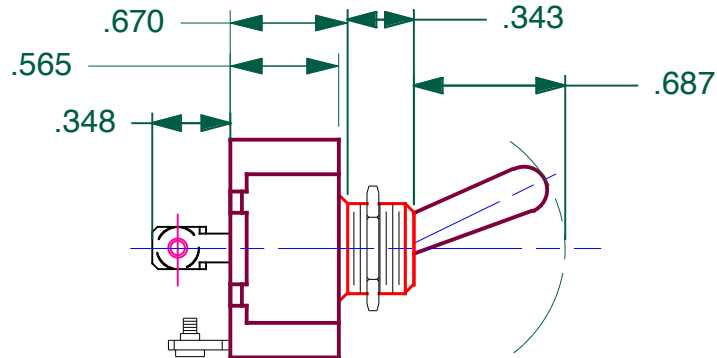
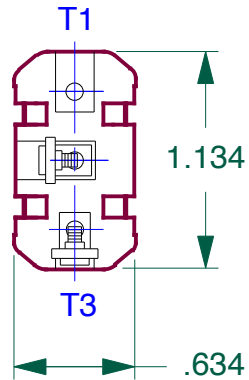
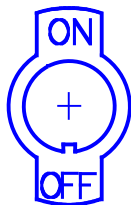

INDICATOR PLATE

HEX NUT  
(FURN. ASS'Y)  
NICKEL PLATED

$\frac{15}{32}$  - 32NS - 2

.562 DIA

.062

RING NUT  
(BULK)

DWG NO. 6FA58-73/272-06747		REV. —
LET	REVISIONS	DATE

<u>RATING</u>	UL & CSA
10A	<u>250VAC</u>
15A	125VAC
3/4HP	<u>120-240VAC</u>

OPERATES:

POSITIONS OF TOGGLE

<u>UP</u> ON	<u>CENTER</u> NONE	<u>DOWN</u> (OFF)
2- 3		

NOTES

- KEYWAY INDICATES DOWN POSITION
- TOGGLE, BUSHING, RING NUT, AND HEX NUT ARE NICKEL PLATED BRASS

DIMENSIONS SUBJECT TO CHANGE WITHOUT NOTICE

FINISH

CARLINGSWITCH, INC.  
PLAINVILLE, CT

**PROPRIETARY NOTE:**

NOTICE TO ALL PERSONS RECEIVING THIS DRAWING. THIS DOCUMENT IS THE PROPERTY OF CARLINGSWITCH, INC. AND IS NOT TO BE DISCLOSED, REPRODUCED IN WHOLE OR IN PART OR USED FOR MANUFACTURING PURPOSES BY ANYONE WITHOUT THE CONSENT OF CARLINGSWITCH, INC.

UNSPECIFIED TOLERANCES

FRAC.  $\pm 1/64$  X.XXX  $\pm .015$   
ANGLES  $\pm 1^\circ$

PROJECTIONS



DIMENSIONS  
IN [mm]

TOOL NO.

REV

DR BY

E.OLSON

DATE

6-10-14

CHK BY

DATE

APPD BY

DATE

TITLE

F SERIES  
TOGGLE SWITCH

SIZE

A

DWG NO.

6FA58-73/272-06747

REV.

—

USED ON

SCALE:

NONE

SHT

1

OF

1